

#### 4 Padua Street Clyde VIC

4  2  2 

Welcome to 4 Padua street Clyde , a beautiful family home located in the sought-after suburb of Clyde.

This immaculate property offers a perfect blend of modern design, comfort, and convenience, making it an ideal choice for growing families. With its spacious interiors, luxurious features, and a prime location, this home is sure to impress.

Step inside and be greeted by the spacious and light-filled living areas that provide the perfect setting for relaxation and entertainment. The open-plan living and dining area seamlessly flows into the modern kitchen, creating a central hub for family gatherings.

The kitchen is a chef's delight, boasting high-quality

**Type** : House  
**Land Size** : 294 sqm  
**View** : <https://www.journeyrealestate.com.au/8193678>



**Arjun Singh**  
 03 5930 7100



**Sam Singh**  
 03 5930 7100

[For full version visit the website](https://www.journeyrealestate.com.au)

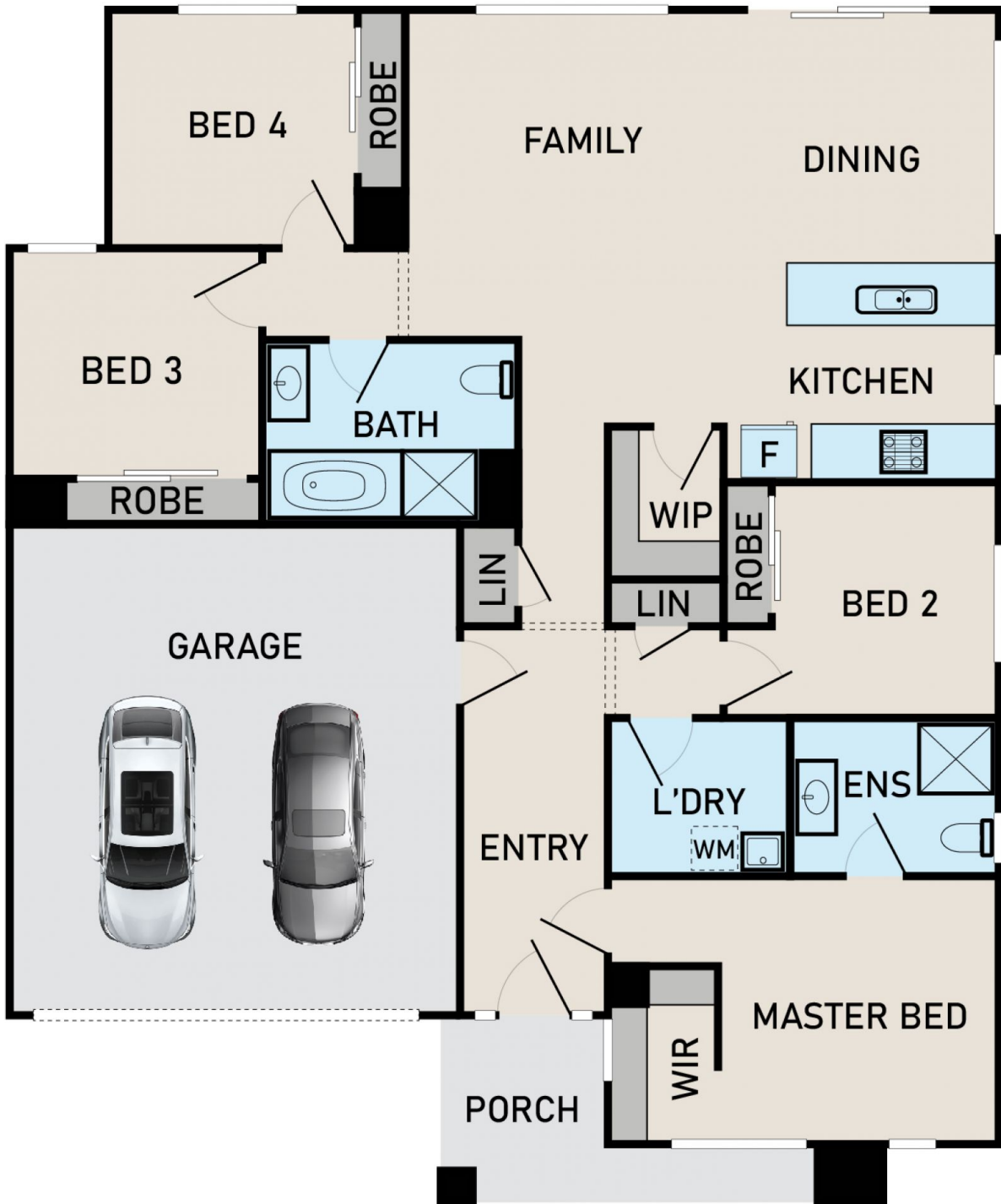

## 4 PADUA STREET, CLYDE VIC 3978

\* Dimensions are approximate and for illustrative purposes only